

**Padlocks**

**Iustus**

**Aditus**

Code  
Status  
Single package  
Multiple package  
Min. ord.

## Iustus

Open shackle IUSTUS padlock. **BODY MATERIAL: BRASS, MM. 20.** Chrome-plated steel shackle D3.  
**SHACKLE CLEARANCE MM. 12. 2 KEYS.**

800207 A 1 12 12

Open shackle IUSTUS padlock. **BODY MATERIAL: BRASS, MM. 25.** Chrome-plated steel shackle D4.  
**SHACKLE CLEARANCE MM. 15. 2 KEYS.**

800257 A 1 12 12

Open shackle IUSTUS padlock. **BODY MATERIAL: BRASS, MM. 25.** Chrome-plated steel shackle D4.  
**SHACKLE CLEARANCE MM. 15. 2 KEYS. CODING AT OUR CHOICE.**

800257..K B 1 12 12

Open shackle IUSTUS padlock. **BODY MATERIAL: BRASS, MM. 25.** Chrome-plated steel shackle D4.  
**SHACKLE CLEARANCE MM. 15. 2 KEYS.**

Fixed coding 061	800257..K1	A	1	12	12
Fixed coding 062	800257..K2	B	1	12	12
Fixed coding 063	800257..K3	D	1	12	12
Fixed coding 064	800257..K4	B	1	12	12
Fixed coding 065	800257..K5	D	1	12	12

Open shackle IUSTUS padlock. **BODY MATERIAL: BRASS, MM. 30.** Chrome-plated steel shackle D5.  
**SHACKLE CLEARANCE MM. 18. 2 KEYS.**

800307 A 1 12 12

Open shackle IUSTUS padlock. **BODY MATERIAL: BRASS, MM. 30.** Chrome-plated steel shackle D5.  
**SHACKLE CLEARANCE MM. 18. 2 KEYS. CODING AT OUR CHOICE**

800307..K A 1 12 12

Open shackle IUSTUS padlock. **BODY MATERIAL: BRASS, MM. 30.** Chrome-plated steel shackle D5.  
**SHACKLE CLEARANCE MM. 18. 2 KEYS**

Fixed coding 2141	800307..K1	B	1	12	12
Fixed coding 2222	800307..K2	B	1	12	12
Fixed coding 2243	800307..K3	D	1	12	12
Fixed coding 2164	800307..K4	B	1	12	12
Fixed coding 2185	800307..K5	D	1	12	12

Open shackle IUSTUS padlock. **BODY MATERIAL: BRASS, MM. 40.** Chrome-plated steel shackle D6.  
**SHACKLE CLEARANCE MM. 22. 2 KEYS.** Antipick disk.

800407 A 1 12 12

Open shackle IUSTUS padlock. **BODY MATERIAL: BRASS, MM. 40.** Chrome-plated steel shackle D6.  
**SHACKLE CLEARANCE MM. 22. 2 KEYS. CODING AT OUR CHOICE.**

Antipick disk. 800407..K A 1 12 12

Open shackle IUSTUS padlock. **BODY MATERIAL: BRASS, MM. 40.** Chrome-plated steel shackle D6.  
**SHACKLE CLEARANCE MM. 22. 2 KEYS** (key/blank 020159).

Antipick disk.					
Fixed coding 3151	800407..K1	B	1	12	12
Fixed coding 3152	800407..K2	B	1	12	12
Fixed coding 3153	800407..K3	B	1	12	12
Fixed coding 3154	800407..K4	D	1	12	12
Fixed coding 3155	800407..K5	D	1	12	12

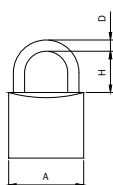

A	H	D
20	12	3
25	15	4
30	18	5
40	22	6
45	25	7
50	28	8
60	35	10
70	44	12

Code  
Status  
Single package  
Multiple package  
Min. ord.

## Iustus

Open shackle IUSTUS padlock. **BODY MATERIAL: BRASS, MM. 45.** Chrome-plated steel shackle D7.  
**SHACKLE CLEARANCE MM. 25. 2 KEYS.** (key blank code: 020259).

Antipick disk.

800457 A 1 6 6

Open shackle IUSTUS padlock. **BODY MATERIAL: BRASS, MM. 45.** Chrome-plated steel shackle D7.  
**SHACKLE CLEARANCE MM. 25. 2 KEYS.** (key blank code: 020259). **CODING ON REQUEST.**

Antipick disk.

800457..5 A 1 6 6

Open shackle IUSTUS padlock. **BODY MATERIAL: BRASS, MM. 45.** Chrome-plated steel shackle D7.  
**SHACKLE CLEARANCE MM. 25. 2 KEYS.** (key blank code: 020259). **CODING AT OUR CHOICE**

Antipick disk.

800457..K A 1 6 6

Open shackle IUSTUS padlock. **BODY MATERIAL: BRASS, MM. 50.** Chrome-plated steel shackle D8.  
**SHACKLE CLEARANCE MM. 28. 2 KEYS.** (key blank code: 020259).

Antipick disk.

800507 A 1 6 6

Open shackle IUSTUS padlock. **BODY MATERIAL: BRASS, MM. 50.** Chrome-plated steel shackle D8.  
**SHACKLE CLEARANCE MM. 28. 2 KEYS.** (key blank code: 020259). **CODING ON REQUEST.**

Antipick disk.

800507..5 D 1 6 1

Open shackle IUSTUS padlock. **BODY MATERIAL: BRASS, MM. 50.** Chrome-plated steel shackle D8.  
**SHACKLE CLEARANCE MM. 28. 2 KEYS.** (key blank code: 020259). **CODING AT OUR CHOICE.**

Antipick disk.

800507..K A 1 6 6

Open shackle IUSTUS padlock. **BODY MATERIAL: BRASS, MM. 50.** Chrome-plated steel shackle D8.  
**SHACKLE CLEARANCE MM. 28. 2 KEYS.** (key blank code: 020259). Antipick disk.

Fixed coding 4031

800507..K1 B 1 6 6

Fixed coding 4032

800507..K2 C 1 6 6

Fixed coding 4063

800507..K3 D 1 6 6

Fixed coding 4084

800507..K4 D 1 6 6

Fixed coding 4135

800507..K5 D 1 6 6

Open shackle IUSTUS padlock. **BODY MATERIAL: BRASS, MM.60.** Chrome-plated steel shackle D10.  
**SHACKLE CLEARANCE MM. 35. 2 KEYS.** (key blank code: 020259).

Antipick disk.

800607 A 1 6 6

Open shackle IUSTUS padlock. **BODY MATERIAL: BRASS, MM.60.** Chrome-plated steel shackle D10.  
**SHACKLE CLEARANCE MM. 35. 2 KEYS.** (key blank code: 020259). **CODING ON REQUEST.**

Antipick disk.

800607..5 D 1 6 1

Open shackle IUSTUS padlock. **BODY MATERIAL: BRASS, MM.60.** Chrome-plated steel shackle D10.  
**SHACKLE CLEARANCE MM. 35. 2 KEYS.** (key blank code: 020259). **CODING AT OUR CHOICE.**

Antipick disk.

800607..K B 1 6 6

Open shackle IUSTUS padlock. **BODY MATERIAL: BRASS, MM.60.** Chrome-plated steel shackle D10.  
**SHACKLE CLEARANCE MM. 35. 2 KEYS.** (key blank code: 020259). Antipick disk.

Fixed coding 5081

800607..K1 D 1 6 6

Fixed coding 5082

800607..K2 D 1 6 6

Fixed coding 5193

800607..K3 D 1 6 6

Fixed coding 5204

800607..K4 D 1 6 6

Fixed coding 5215

800607..K5 D 1 6 6



A	H	D
20	12	3
25	15	4
30	18	5
40	22	6
45	25	7
50	28	8
60	35	10
70	44	12

## Iustus

Code  
Status  
Single package  
Multiple package  
Min. ord.

Open shackle IUSTUS padlock. **BODY MATERIAL: BRASS, MM.70.** Chrome-plated steel shackle D12.  
**SHACKLE CLEARANCE MM. 44. 2 KEYS.** (key blank code: 020259).

Antipick disk. **800707** B 1 6 6

Open shackle IUSTUS padlock. **BODY MATERIAL: BRASS, MM.70.** Chrome-plated steel shackle D12.  
**SHACKLE CLEARANCE MM. 44. 2 KEYS.** (key blank code: 020259). **CODING ON REQUEST.**

Antipick disk. **800707..5** D 1 6 1

Open shackle IUSTUS padlock. **BODY MATERIAL: BRASS, MM.70.** Chrome-plated steel shackle D12.  
**SHACKLE CLEARANCE MM. 44. 2 KEYS.** (key blank code: 020259). **CODING AT OUR CHOICE.**

Antipick disk. **800707..K** D 1 6 6

Open shackle IUSTUS padlock. **BODY MATERIAL: BRASS, MM.70.** Chrome-plated steel shackle D12.  
**SHACKLE CLEARANCE MM. 44. 2 KEYS.** (key blank code: 020259).

Antipick disk.

Fixed coding 6061 **800707..K1** D 1 6 6

Fixed coding 6062 **800707..K2** D 1 6 6

Fixed coding 6103 **800707..K3** D 1 6 6

Fixed coding 6104 **800707..K4** D 1 6 6

Fixed coding 6105 **800707..K5** D 1 6 6

Long shackle IUSTUS padlock. **BODY MATERIAL: BRASS, MM.25.** Chrome-plated steel shackle D4.  
**SHACKLE CLEARANCE MM. 25. 2 KEYS.**

**802257** B 1 12 12

Long shackle IUSTUS padlock. **BODY MATERIAL: BRASS, MM.25.** Chrome-plated steel shackle D4.  
**SHACKLE CLEARANCE MM. 25. 2 KEYS. CODING AT OUR CHOICE.**

**802257..K** D 1 12 12

Long shackle IUSTUS padlock. **BODY MATERIAL: BRASS, MM.30.** Chrome-plated steel shackle D5.  
**SHACKLE CLEARANCE MM. 46. 2 KEYS.**

**802307** A 1 12 12

Long shackle IUSTUS padlock. **BODY MATERIAL: BRASS, MM.30.** Chrome-plated steel shackle D5.  
**SHACKLE CLEARANCE MM. 46. 2 KEYS. CODING AT OUR CHOICE.**

**802307..K** B 1 12 12

Long shackle IUSTUS padlock. **BODY MATERIAL: BRASS, MM.30.** Chrome-plated steel shackle D5.  
**SHACKLE CLEARANCE MM. 67. 2 KEYS.**

**802317** B 1 12 12

Long shackle IUSTUS padlock. **BODY MATERIAL: BRASS, MM.30.** Chrome-plated steel shackle D5.  
**SHACKLE CLEARANCE MM. 67. 2 KEYS. CODING AT OUR CHOICE.**

**802317..K** D 1 12 12

Long shackle IUSTUS padlock. **BODY MATERIAL: BRASS, MM.30.** Chrome-plated steel shackle D5.  
**SHACKLE CLEARANCE MM. 100. 2 KEYS.**

**802327** C 1 12 12

Long shackle IUSTUS padlock. **BODY MATERIAL: BRASS, MM.30.** Chrome-plated steel shackle D5.  
**SHACKLE CLEARANCE MM. 100. 2 KEYS. CODING AT OUR CHOICE.**

**802327..K** D 1 12 12

Long shackle IUSTUS padlock. **BODY MATERIAL: BRASS, MM.40.** Chrome-plated steel shackle D6.  
**SHACKLE CLEARANCE MM. 47. 2 KEYS.** Antipick disk.

**802407** A 1 12 12

Long shackle IUSTUS padlock. **BODY MATERIAL: BRASS, MM.40.** Chrome-plated steel shackle D6.  
**SHACKLE CLEARANCE MM. 47. 2 KEYS.** Antipick disk. **CODING AT OUR CHOICE.**

**802407..K** B 1 12 12

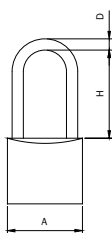

	A	H	D
25	25	25	4
30	30	46	5
31	30	67	5
40	40	47	6
41	40	67	6
50	50	50	8
51	50	67	8
52	50	90	8

Code  
Status  
Single package  
Multiple package  
Min. ord.

## Iustus

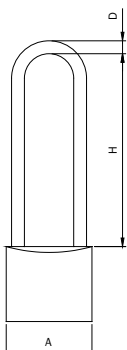

Long shackle IUSTUS padlock. **BODY MATERIAL: BRASS, MM.40.** Chrome-plated steel shackle D6.  
**SHACKLE CLEARANCE MM. 67. 2 KEYS.** Antipick disk.

802417 B 1 12 12

Long shackle IUSTUS padlock. **BODY MATERIAL: BRASS, MM.40.** Chrome-plated steel shackle D6.  
**SHACKLE CLEARANCE MM. 67. 2 KEYS. CODING AT OUR CHOICE.** Antipick disk.

802417..K D 1 12 12

Long shackle IUSTUS padlock. **BODY MATERIAL: BRASS, MM.40.** Chrome-plated steel shackle D6.  
**SHACKLE CLEARANCE MM. 90. 2 KEYS.** Antipick disk.

802427 C 1 12 12

Long shackle IUSTUS padlock. **BODY MATERIAL: BRASS, MM.40.** Chrome-plated steel shackle D6.  
**SHACKLE CLEARANCE MM. 90. 2 KEYS. CODING AT OUR CHOICE.** Antipick disk.

802427..K D 1 12 12

Long shackle IUSTUS padlock. **BODY MATERIAL: BRASS, MM.50.** Chrome-plated steel shackle D8.  
**SHACKLE CLEARANCE MM. 50. 2 KEYS.** (key blank code: 020259). Antipick disk.

802507 A 1 6 6

Long shackle IUSTUS padlock. **BODY MATERIAL: BRASS, MM.50.** Chrome-plated steel shackle D8.  
**SHACKLE CLEARANCE MM. 50. 2 KEYS** (key blank code: 020259). **CODING ON REQUEST.** Antipick disk.

802507..5 D 1 6 1

Long shackle IUSTUS padlock. **BODY MATERIAL: BRASS, MM.50.** Chrome-plated steel shackle D8.  
**SHACKLE CLEARANCE MM. 50. 2 KEYS.** (key blank code: 020259). **CODING AT OUR CHOICE.** Antipick disk

802507..K C 1 6 6

Long shackle IUSTUS padlock. **BODY MATERIAL: BRASS, MM.50.** Chrome-plated steel shackle D8.  
**SHACKLE CLEARANCE MM. 67. 2 KEYS.** (key blank code: 020259). Antipick disk.

802517 C 1 6 6

Long shackle IUSTUS padlock. **BODY MATERIAL: BRASS, MM.50.** Chrome-plated steel shackle D8.  
**SHACKLE CLEARANCE MM. 67. 2 KEYS.** (key blank code: 020259). **CODING ON REQUEST.** Antipick disk.

802517..5 D 1 6 1

Long shackle IUSTUS padlock. **BODY MATERIAL: BRASS, MM.50.** Chrome-plated steel shackle D8.  
**SHACKLE CLEARANCE MM. 67. 2 KEYS.** (key blank code: 020259). **CODING AT OUR CHOICE.** Antipick disk.

802517..K D 1 6 6

Long shackle IUSTUS padlock. **BODY MATERIAL: BRASS, MM.50.** Chrome-plated steel shackle D8.  
**SHACKLE CLEARANCE MM. 90. 2 KEYS.** (key blank code: 020259). Antipick disk.

802527 C 1 6 6

Long shackle IUSTUS padlock. **BODY MATERIAL: BRASS, MM.50.** Chrome-plated steel shackle D8.  
**SHACKLE CLEARANCE MM. 90. 2 KEYS.** (key blank code: 020259). **CODING ON REQUEST.** Antipick disk.

802527..5 D 1 6 1

Long shackle IUSTUS padlock. **BODY MATERIAL: BRASS, MM.50.** Chrome-plated steel shackle D8.  
**SHACKLE CLEARANCE MM. 90. 2 KEYS.** (key blank code: 020259). **CODING AT OUR CHOICE.** Antipick disk.

802527..K D 1 6 6

Long shackle IUSTUS padlock. **BODY MATERIAL: BRASS, MM.50.** Chrome-plated steel shackle D8.  
**SHACKLE CLEARANCE MM. 152. 2 KEYS.** (key blank code: 020259). Antipick disk.

802537 C 1 6 6

Long shackle IUSTUS padlock. **BODY MATERIAL: BRASS, MM.50.** Chrome-plated steel shackle D8.  
**SHACKLE CLEARANCE MM. 152. 2 KEYS.** (key blank code: 020259). **CODING ON REQUEST.** Antipick disk.

802537..5 D 1 6 1

Long shackle IUSTUS padlock. **BODY MATERIAL: BRASS, MM.50.** Chrome-plated steel shackle D8.  
**SHACKLE CLEARANCE MM. 152. 2 KEYS.** (key blank code: 020259). **CODING AT OUR CHOICE.** Antipick disk.

802537..K D 1 6 6

	A	H	D
32	30	100	5
42	40	90	6
50	50	50	8
51	50	67	8
53	50	152	8

Code  
Status  
Single package  
Multiple package  
Min. ord.

## Iustus

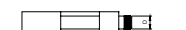
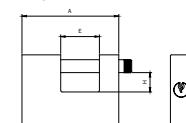

A	E	H	D
70	20	15	12
90	36	18	12

RECTANGULAR IUSTUS padlock for gates. **BRASS BODY MM.70.** Shaft material: chrome-plated carbonitrided steel D 12, opening grip. Shaft ball-locking. **SHAFT CLEARANCE MM. 20 X 15.**

**2 KEYS.** (key blank code: 020259).

**804707** A 1 6 6

RECTANGULAR IUSTUS padlock for gates. **BRASS BODY MM.70.** Shaft material: chrome-plated carbonitrided steel D 12, opening grip. Shaft ball-locking. **SHAFT CLEARANCE MM. 20 X 15.**

**2 KEYS.** (key blank code: 020259). **CODING ON REQUEST.**

**804707..5** D 1 6 1

RECTANGULAR IUSTUS padlock for gates. **BRASS BODY MM.70.** Shaft material: chrome-plated carbonitrided steel D 12, opening grip. Shaft ball-locking. **SHAFT CLEARANCE MM. 20 X 15.**

**2 KEYS.** (key blank code: 020259). **CODING AT OUR CHOICE.**

**804707..K** B 1 6 6

RECTANGULAR IUSTUS padlock for gates. **BRASS BODY MM.90.** Shaft material: chrome-plated carbonitrided steel D 12, opening grip. Shaft ball-locking. Shaft clearance mm. 36x18.

**2 KEYS.** (key blank code: 020259).

**804907** A 1 6 6

RECTANGULAR IUSTUS padlock for gates. **BRASS BODY MM.90.** Shaft material: chrome-plated carbonitrided steel D 12, opening grip. Shaft ball-locking. **SHAFT CLEARANCE MM. 36X18.**

**2 KEYS.** (key blank code: 020259). **CODING ON REQUEST.**

**804907..5** D 1 6 1

RECTANGULAR IUSTUS padlock for gates. **BRASS BODY MM.90.** Shaft material: chrome-plated carbonitrided steel D 12, opening grip. Shaft ball-locking. **SHAFT CLEARANCE MM. 36X18.**

**2 KEYS.** (key blank code: 020259). **CODING AT OUR CHOICE.**

**804907..K** C 1 6 6

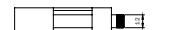
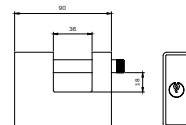

RECTANGULAR **ARMOURED** IUSTUS padlock for gates. Brass body mm.90. Armour material: chrome-plated, carbonitrided steel. Shaft material: chrome-plated carbonitrided steel D 12, opening grip, Shaft ball-locking.

**2 KEYS.** (key blank code: 020259). **SHAFT CLEARANCE MM. 36 X 18.**

**805909** A 1 6 6

RECTANGULAR **ARMOURED** IUSTUS padlock for gates. Brass body mm.90. Armour material: chrome-plated, carbonitrided steel. Shaft material: chrome-plated carbonitrided steel D 12, opening grip, Shaft ball-locking.

**2 KEYS.** (key blank code: 020259). **SHAFT CLEARANCE MM. 36 X 18. CODING ON REQUEST**

**805909..5** D 1 6 1

RECTANGULAR **ARMOURED** IUSTUS padlock for gates. Brass body mm.90. Armour material: chrome-plated, carbonitrided steel. Shaft material: chrome-plated carbonitrided steel D 12, opening grip, Shaft ball-locking.

**SHAFT CLEARANCE MM. 36 X 18. CODING AT OUR CHOICE. 2 KEYS.** (key blank code: 020259).

**805909..K** B 1 6 6

Code  
Status  
Single package  
Multiple package  
Min. ord.

## Iustus



RECTANGULAR GATE padlock BOXER, **FULLY ARMoured**, for gates. Body material: Zama zinc alloy. Armour material: chrome-plated carbonitrided steel. Shaft material: chrome-plated carbonitrided steel, mm 90. It operates with European single-profile cylinder **F5** mm. 40 (30+10), supplied with off-center cam art. 820930107. Stainless steel shaft D 12, opening grip. Shaft ball-locking. **SHAFT CLEARANCE MM. 36 X 17,5.**

When the padlock is open the armour can be removed to replace the cylinder. **3 KEYS.** (key blank code: 020259). **809909** A 1 - 1



RECTANGULAR GATE padlock BOXER, **FULLY ARMoured**, for gates. Body material: Zama zinc alloy. Armour material: chrome-plated carbonitrided steel mm. 40 (30+10), supplied with off-center cam art. 820930107. Stainless steel shaft D 12, opening grip. Shaft ball-locking. **SHAFT CLEARANCE MM. 36 X 17,5.**

When the padlock is open the armour can be removed to replace the cylinder. **3 KEYS.** (key blank code: 020259). **809909..5** D 1 - 1

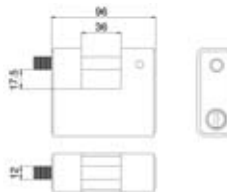

RECTANGULAR GATE padlock BOXER, **FULLY ARMoured**, for gates. Body material: Zama zinc alloy. Armour material: chrome-plated carbonitrided steel. Shaft material: chrome-plated carbonitrided steel, mm 90. It operates with European single-profile cylinder **F5** carbonitrided steel mm. 40 (30+10), supplied with off-center cam art. 820930107. Stainless steel shaft D 12, opening grip. Shaft ball-locking. **SHAFT CLEARANCE MM. 36 X 17,5.**

When the padlock is open the armour can be removed to replace the cylinder. **3 KEYS.** (key blank code: 020259). **809909..K** C 1 - 1



RECTANGULAR GATE padlock BOXER, **FULLY ARMoured**, for gates. Body material: Zama zinc alloy. Armour material: chrome-plated carbonitrided steel. Shaft material: chrome-plated carbonitrided steel, mm 90. It operates with European single-profile cylinder **F6** carbonitrided steel mm. 40 (30+10), supplied with off-center cam art. 810930107. Stainless steel shaft D 12, opening grip. Shaft ball-locking. **SHAFT CLEARANCE MM. 36 X 17,5.**

When the padlock is open the armour can be removed to replace the cylinder. **3 KEYS.** (key blank code: 020609). **809909..F6** B 1 - 1

RECTANGULAR GATE padlock BOXER, **FULLY ARMoured**, for gates. Body material: Zama zinc alloy. Armour material: chrome-plated carbonitrided steel. Shaft material: chrome-plated carbonitrided steel, mm 90. It operates with European single-profile cylinder **F6** carbonitrided steel mm. 40 (30+10), supplied with off-center cam art. 810930107.8 Stainless steel shaft D 12, opening grip. Shaft ball-locking. **SHAFT CLEARANCE MM. 36 X 17,5.**

When the padlock is open the armour can be removed to replace the cylinder. **3 KEYS.** (key blank code: 020609). **CODING ON REQUEST.** **809909.8F6** D 1 - 1

RECTANGULAR GATE padlock BOXER, **FULLY ARMoured**, for gates. Body material: Zama zinc alloy. Armour material: chrome-plated carbonitrided steel. Shaft material: chrome-plated carbonitrided steel, mm 90. It operates with European single-profile cylinder **F6** carbonitrided steel mm. 40 (30+10), supplied with off-center cam art. 810930107. Stainless steel shaft D 12, opening grip. Shaft ball-locking. **SHAFT CLEARANCE MM. 36 X 17,5.**

When the padlock is open the armour can be removed to replace the cylinder. **3 KEYS.** (key blank code: 020609). **CODING AT OUR CHOICE.** **809909..KF6** D 1 - 1



RECTANGULAR GATE padlock BOXER, **FULLY ARMoured**, for gates. Body material: Zama zinc alloy. Armour material: chrome-plated carbonitrided steel. Shaft material: chrome-plated carbonitrided steel, mm 90. It operates with European single-profile cylinder **R6** mm. 40 (30+10), supplied with off-center cam art. 820930107. Stainless steel shaft D 12, opening grip. Shaft ball-locking. **SHAFT CLEARANCE MM. 36 X 17,5.** (key blank code: 020809).

When the padlock is open the armour can be removed to replace the cylinder. **3 KEYS.** **809909.R6** B 1 - 1

RECTANGULAR GATE padlock BOXER, **FULLY ARMoured**, for gates. Body material: Zama zinc alloy. Armour material: chrome-plated carbonitrided steel. Shaft material: chrome-plated carbonitrided steel, mm 90. It operates with European single-profile cylinder **R6** mm. 40 (30+10), supplied with off-center cam art. 880930109.8. Stainless steel shaft D 12, opening grip. Shaft ball-locking. **SHAFT CLEARANCE MM. 36 X 17,5.** (key blank code: 020809).

When the padlock is open the armour can be removed to replace the cylinder. **3 KEYS. CODING ON REQUEST.** **809909.8R6** D 1 - 1



Code  
Status  
Single package  
Multiple package  
Min. ord.

## Iustus

RECTANGULAR GATE padlock BOXER, **FULLY ARMoured**, for gates. Body material: Zama zinc alloy. Armour material: chrome-plated carbonitrided steel. Shaft material: chrome-plated carbonitrided steel, mm 90. It operates with European single-profile cylinder **R6** mm. 40 (30+10), supplied with off-center cam art. 880930109.8.

Stainless steel shaft D 12, opening grip. Shaft ball-locking. **SHAFT CLEARANCE MM. 36 X 17,5.**

When the padlock is open the armour can be removed to replace the cylinder. **3 KEYS.**

(key blank code: 020809). **CODING AT OUR CHOICE.**

809909..KR6 D 1 - 1



RECTANGULAR GATE padlock BOXER, **FULLY ARMoured**, for gates. Body material: Zama zinc alloy. Armour material: chrome-plated carbonitrided steel. Shaft material: chrome-plated carbonitrided steel, mm 90. It operates with European single-profile cylinder **R7** mm. 40 (30+10), supplied with off-center cam art.89R7030109.

Stainless steel shaft D 12, opening grip. Shaft ball-locking. **SHAFT CLEARANCE MM. 36 X 17,5.** When the

padlock is open the armour can be removed to replace the cylinder. **3 KEYS.** (key blank code: 020909).

809909..R7 D 1 - 1

RECTANGULAR GATE padlock BOXER, **FULLY ARMoured**, for gates. Body material: Zama zinc alloy.

Armour material: chrome-plated carbonitrided steel. Shaft material: chrome-plated carbonitrided steel, mm 90.

It operates with European single-profile cylinder **R7** mm. 40 (30+10), supplied with off-center cam art.89R7030109.8.

Stainless steel shaft D 12, opening grip. Shaft ball-locking. **SHAFT CLEARANCE MM. 36 X 17,5.** When the

padlock is open the armour can be removed to replace the cylinder. **3 KEYS.** (key blank code: 020909).

**CODING ON REQUEST.**

809909.8R7 D 1 - 1

RECTANGULAR GATE padlock BOXER, **FULLY ARMoured**, for gates. Body material: Zama zinc alloy. Armour material: chrome-plated carbonitrided steel. Shaft material: chrome-plated carbonitrided steel, mm 90. It operates with European single-profile cylinder **R7** mm. 40 (30+10), supplied with off-center cam art.89R7030109.8.

Stainless steel shaft D 12, opening grip. Shaft ball-locking. **SHAFT CLEARANCE MM. 36 X 17,5.**

When the padlock is open the armour can be removed to replace the cylinder. **3 KEYS.** (key blank code: 020909).

**CODING AT OUR CHOICE.**

809909.KR7 D 1 - 1



RECTANGULAR GATE padlock BOXER, **FULLY ARMoured**, for gates. Body material: Zama zinc alloy. Armour material: chrome-plated carbonitrided steel. Shaft material: chrome-plated carbonitrided steel, mm 90. It operates with European single-profile cylinder **R7** mm. 40 (30+10) off-center cam. Stainless steel shaft D 12, opening grip.

Shaft ball-locking. **SHAFT CLEARANCE MM. 36 X 17,5.**

When the padlock is open the armour can be removed to replace the cylinder.

809909I B 1 - 1

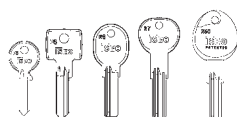
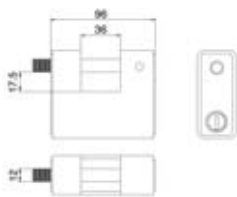



Code  
Status  
Single  
package  
Multiple  
package  
Min. ord.

## Aditus



Open-shackle ADITUS padlock. **BODY: SATIN POLISHED BRASS MM. 20.** Tempered and chrome-plated steel shackle D 3,5 **SHACKLE CLEARANCE MM. 10. 2 KEYS**

P00020127 A 1 12 12

Open-shackle ADITUS padlock. **BODY: SATIN POLISHED BRASS MM. 20.** Tempered and chrome-plated steel shackle D 3,5 **SHACKLE CLEARANCE MM. 10. 2 KEYS. CODING AT OUR CHOICE.**

P00020127.K B 1 12 12



Open-shackle ADITUS padlock. **BODY: SATIN POLISHED BRASS MM. 25.** Tempered and chrome-plated steel shackle D 4,2 **SHACKLE CLEARANCE MM. 15,5. 2 KEYS**

P00025157 A 1 12 12

Open-shackle ADITUS padlock. **BODY: SATIN POLISHED BRASS MM. 25.** Tempered and chrome-plated steel shackle D 4,2 **SHACKLE CLEARANCE MM. 15,5. 2 KEYS CODING AT OUR CHOICE.**

P00025157.K B 1 12 12

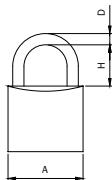

Open-shackle ADITUS padlock. **Body: satin polished brass mm. 25.** Tempered and chrome-plated steel shackle D 4,2 **SHACKLE CLEARANCE MM. 25. 2 KEYS**

P00025257 B 1 12 12

Open-shackle ADITUS padlock. **BODY: SATIN POLISHED BRASS MM. 25.** Tempered and chrome-plated steel shackle D 4,2 **SHACKLE CLEARANCE MM. 25. 2 KEYS. CODING AT OUR CHOICE.**

P00025257.K D 1 12 12

	A	H	D
P00020127	20	10	3,5
P00025157	25	15,5	4,2
P00025257	25	25	4,2
P00030167	30	16	5,1
P00030467	30	46	5,1
P00040217	40	23,9	5,1
P00040477	40	47	6,3
P00040707	40	70	6,3
P00050277	50	29,5	8,0
P00050507	50	50	8,0
P00060377	60	37,5	9,5
P00070427	70	41	11,0

Open-shackle ADITUS padlock. **BODY: SATIN POLISHED BRASS MM. 30.** Tempered and chrome-plated steel shackle D 5,1 **SHACKLE CLEARANCE MM. 16. 2 KEYS**

P00030167 A 1 12 12

Open-shackle ADITUS padlock. **BODY: SATIN POLISHED BRASS MM. 30.** Tempered and chrome-plated steel shackle D 5,1 **SHACKLE CLEARANCE MM. 16. 2 KEYS CODING AT OUR CHOICE.**

P00030167.K B 1 12 12

Open-shackle ADITUS padlock. **BODY: SATIN POLISHED BRASS MM. 30.** Tempered and chrome-plated steel shackle D 5,1 **SHACKLE CLEARANCE MM. 46. 2 KEYS**

P00030467 B 1 12 12

Open-shackle ADITUS padlock. **BODY: SATIN POLISHED BRASS MM. 30.** Tempered and chrome-plated steel shackle D 5,1 **SHACKLE CLEARANCE MM. 46. 2 KEYS CODING AT OUR CHOICE.**

P00030467.K D 1 12 12



Open-shackle ADITUS padlock. **BODY: SATIN POLISHED BRASS MM. 40.** Tempered and chrome-plated steel shackle D 6,3 **SHACKLE CLEARANCE MM. 23,9. 2 KEYS**

P00040217 A 1 12 12

Open-shackle ADITUS padlock. **BODY: SATIN POLISHED BRASS MM. 40.** Tempered and chrome-plated steel shackle D 6,3 **SHACKLE CLEARANCE MM. 23,9. 2 KEYS. CODING AT OUR CHOICE.**

P00040217.K B 1 12 12



Open-shackle ADITUS padlock. **BODY: SATIN POLISHED BRASS MM. 40.** Tempered and chrome-plated steel shackle D 6,3 **SHACKLE CLEARANCE MM. 47. 2 KEYS**

P00040477 B 1 12 12

Open-shackle Aditus padlock. **Body: satin polished brass mm. 40.** Tempered and chrome-plated steel shackle D 6,3 **SHACKLE CLEARANCE MM. 47. 2 KEYS. CODING AT OUR CHOICE.**

P00040477.K C 1 12 12

Open-shackle ADITUS padlock. **BODY: SATIN POLISHED BRASS MM. 40.** Tempered and chrome-plated steel shackle D 6,3 **SHACKLE CLEARANCE MM. 70. 2 KEYS**

P00040707 B 1 12 12

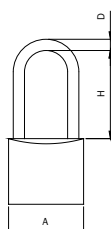

Code  
Status  
Single package  
Multiple package  
Min. ord.

## Aditus

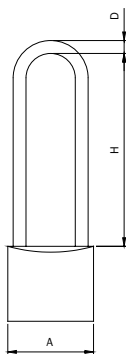

Open-shackle ADITUS padlock. **BODY: SATIN POLISHED BRASS MM. 50.** Tempered and chrome-plated steel shackle D 8 **SHACKLE CLEARANCE MM. 29,5. 2 KEYS.**

P00050277 A 1 6 6

Open-shackle ADITUS padlock. **BODY: SATIN POLISHED BRASS MM. 50.** Tempered and chrome-plated steel shackle D 8 **SHACKLE CLEARANCE MM. 29,5. 2 KEYS. CODING AT OUR CHOICE.**

P00050277.K B 1 6 6

Open-shackle ADITUS padlock. **BODY: SATIN POLISHED BRASS MM. 50.** Tempered and chrome-plated steel shackle D 8 **SHACKLE CLEARANCE MM. 50. 2 KEYS.**

P00050507 B 1 6 6

Open-shackle ADITUS padlock. **BODY: SATIN POLISHED BRASS MM. 50.** Tempered and chrome-plated steel shackle D 8 **SHACKLE CLEARANCE MM. 50. 2 KEYS. CODING AT OUR CHOICE.**

P00050507.K C 1 6 6

Open-shackle ADITUS padlock. **BODY: SATIN POLISHED BRASS MM. 60.** Tempered and chrome-plated steel shackle D 9,5 **SHACKLE CLEARANCE MM. 37,5. 2 KEYS.**

P00060377 A 1 6 6

Open-shackle ADITUS padlock. **BODY: SATIN POLISHED BRASS MM. 60.** Tempered and chrome-plated steel shackle D 9,5 **SHACKLE CLEARANCE MM. 37,5. 2 KEYS. CODING AT OUR CHOICE.**

P00060377.K C 1 6 6

Open-shackle ADITUS padlock. **BODY: SATIN POLISHED BRASS MM. 70.** Tempered and chrome-plated steel shackle D 11 **SHACKLE CLEARANCE MM. 41. 2 KEYS.**

P00070427 B 1 6 6

Open-shackle ADITUS padlock. **Body: satin polished brass mm. 70.** Tempered and chrome-plated steel shackle D 11 **SHACKLE CLEARANCE MM. 41. 2 KEYS. CODING AT OUR CHOICE.**

P00070427.K D 1 6 6

	A	H	D
P00020127	20	10	3,5
P00025157	25	15,5	4,2
P00025257	25	25	4,2
P00030167	30	16	5,1
P00030467	30	46	5,1
P00040217	40	23,9	5,1
P00040477	40	47	6,3
P00040707	40	70	6,3
P00050277	50	29,5	8,0
P00050507	50	50	8,0
P00060377	60	37,5	9,5
P00070427	70	41	11,0

Code  
Status  
Single package  
Multiple package  
Min. ord.

## Aditus



RECTANGULAR ADITUS padlock for gates. **BODY: PAINTED SATIN BRASS MM.50.**

Shaft material: chrome-plated carbonitrided steel D 8. Shaft ball-locking. **SHAFT CLEARANCE MM. 15 X 12,5.**

**2 KEYS.**

P04050177 B 1 12 12

RECTANGULAR ADITUS padlock for gates. **BODY: PAINTED SATIN BRASS MM.50.**

Shaft material: chrome-plated carbonitrided steel D 8. Shaft ball-locking. **SHAFT CLEARANCE MM. 15 X 12,5.**

**2 KEYS. CODING AT OUR CHOICE.**

P04050177.K D 1 12 12



RECTANGULAR ADITUS padlock for gates. **BODY: PAINTED SATIN BRASS MM.60.**

Shaft material: chrome-plated carbonitrided steel D 10. Shaft ball-locking. **SHAFT CLEARANCE MM. 18 X 14**

**2 KEYS.**

P04060187 B 1 6 6

RECTANGULAR ADITUS padlock for gates. **BODY: PAINTED SATIN BRASS MM.60.**

Shaft material: chrome-plated carbonitrided steel D 10. Shaft ball-locking. **SHAFT CLEARANCE MM. 18 X 14**

**2 KEYS. CODING AT OUR CHOICE.**

P04060187.K D 1 6 6

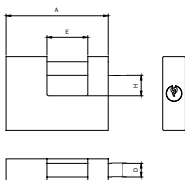

RECTANGULAR ADITUS padlock for gates. **BODY: PAINTED SATIN BRASS MM.70.**

Shaft material: chrome-plated carbonitrided steel D 12. Shaft ball-locking. **SHAFT CLEARANCE MM. 22X14,5**

**2 KEYS.**

P04070127 B 1 6 6

RECTANGULAR ADITUS padlock for gates. **BODY: PAINTED SATIN BRASS MM.70.**

Shaft material: chrome-plated carbonitrided steel D 12. Shaft ball-locking. **SHAFT CLEARANCE MM. 22X14,5**

**2 KEYS. CODING AT OUR CHOICE.**

P04070127.K D 1 6 6

RECTANGULAR ADITUS padlock for gates. **BODY: PAINTED SATIN BRASS MM.90.**

Shaft material: chrome-plated carbonitrided steel D 12. Shaft ball-locking. **SHAFT CLEARANCE MM. 36X19.**

**2 KEYS.**

P04090197 B 1 6 6

	A	E	H	D
P04050177	50	15	12,5	8
P04060187	60	18	14	10
P04070127	68	22	14,5	12
P04090197	90	36	19	12

RECTANGULAR ADITUS padlock for gates. **BODY: PAINTED SATIN BRASS MM.90.**

Shaft material: chrome-plated carbonitrided steel D 12. Shaft ball-locking. **SHAFT CLEARANCE MM. 36X19.**

**2 KEYS. CODING AT OUR CHOICE.**

P04090197.K C 1 6 6

Code  
Status  
Single package  
Multiple package  
Min. ord.

## Aditus



RECTANGULAR **ARMoured** ADITUS padlock for gates. **BRASS BODY MM.60.**

Armour material: chrome-plated, carbonitrided and sand-blasted.

Shaft material: chrome-plated carbonitrided steel D 10,

opening grip. Shaft ball-locking. **SHAFT CLEARANCE MM. 22 X 11,5. 2 KEYS.**

P04960227 B 1 6 6



RECTANGULAR **ARMoured** ADITUS padlock for gates. **BRASS BODY MM.60.**

Armour material: chrome-plated, carbonitrided and sand-blasted.

Shaft material: chrome-plated carbonitrided steel D 10,

Shaft ball-locking. **SHAFT CLEARANCE MM. 22 X 11,5. 2 KEYS. CODING AT OUR CHOICE.**

P04960227.K D 1 6 6

RECTANGULAR **ARMoured** ADITUS padlock for gates. **BRASS BODY MM.70.**

Armour material: chrome-plated, carbonitrided and sand-blasted.

Shaft material: chrome-plated carbonitrided steel D 12,

opening grip. Shaft ball-locking. **SHAFT CLEARANCE MM. 22 X 15. 2 KEYS.**

P04970227 B 1 6 6

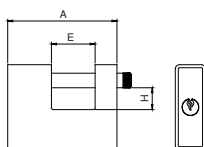

RECTANGULAR **ARMoured** ADITUS padlock for gates. **BRASS BODY MM.70.**

Armour material: chrome-plated, carbonitrided and sand-blasted.

Shaft material: chrome-plated carbonitrided steel D 12,

opening grip. Shaft ball-locking. **SHAFT CLEARANCE MM. 22 X 15. 2 KEYS. CODING AT OUR CHOICE.**

P04970227.K D 1 6 6

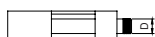

RECTANGULAR **ARMoured** ADITUS padlock for gates. **BRASS BODY MM.90.**

Armour material: chrome-plated, carbonitrided and sand-blasted.

Shaft material: chrome-plated carbonitrided steel D 12,

opening grip. Shaft ball-locking. **SHAFT CLEARANCE MM. MM. 36 X 18. 2 KEYS.**

P04990367 A 1 6 6

	A	E	H	D
P04960227	62	22	11,5	10
P04970227	71	22	15	12
P04990367	91	36	18	12

RECTANGULAR **ARMoured** ADITUS padlock for gates. **BRASS BODY MM.90.**

Armour material: chrome-plated, carbonitrided and sand-blasted.

Shaft material: chrome-plated carbonitrided steel D 12,

opening grip. Shaft ball-locking. **SHAFT CLEARANCE MM. MM. 36 X 18. 2 KEYS. CODING AT OUR CHOICE.**

P04990367.K C 1 6 6

## Accessories

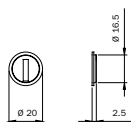

**ANTI-PICK DISK** for padlock 809\* with R6-R11 cylinder for keys with a max. thickness of 3,7mm

004377 D 50 - 50

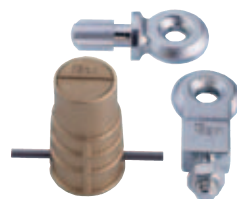
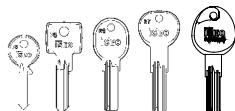

**FLOOR ANCHOR BRASS HOUSING** for rectangular padlocks 804-805-809 series

004907 A 1 - 1

